

NEWS

[<printable version>](#)

Dear eNews reader,

We round off this bygone year with a very nice feeling. 2006 has been an ample year, one of which we especially remember the many warm contacts with you, our clients. Time and time again, these contacts inspire us to make of our eNews something special, as is also the case with this month's version.

The fact that recently the 6.000th CAE version has been installed, also contributes to the overall satisfaction of SCIA. For now we already give you our seasons' greetings and are eager to see you again at the other side of the thin line called 'New Year'.

- » [Corporate News: SCIA, the market leader in structural engineering?](#)
- » [Product News: Interoperability with SCIA•ESA PT 2007](#)
- » [The Market: SCIA continues its internationalisation on new markets](#)
- » [Customer's Project: Electrabel Power Plant in Castelnou \(Spain\)](#)
- » [Tips & Tricks: Partial analyses of structures using layers in SCIA•ESA PT](#)

SCIA, the market leader in structural engineering?

**The cape of 6000 licenses of the SCIA CAE software has been rounded last October;** the majority of our customers is located in Europe (W. & E.), with a focus in the BeNeLux, Germany, Austria, Switzerland, France, Czech Rep., Slovak Rep.; yet an increasing number of customers is also found in other regions such as the U.K., Scandinavia, Serbia, Romania, Italy, Russia, U.S.A, India and Australia. **Another evidence of the ongoing internationalisation: close to 100 projects from 13 countries compete in the ongoing SCIA User Contest 2007!**

In the coming year SCIA will focus on publishing its fundamental technological know-how. **This technology acceptance goes together with the recovery of the Structural Engineering Community.** Construction is up in many segments, be it in infrastructure, buildings or energy plants. The unification of the building codes (with the Eurocodes legally enforced between 2007 and 2010) and the introduction of B.I.M. (Building Information Modelling) solutions support the use of the SCIA software.

**We thank all SCIA customers for their contribution to our achievement and wish you all a successful, busy 'end-of-the-year' business!**

[▲ top](#)

Sneak Preview: Interoperability with SCIA•ESA PT 2007

The **open platform** of **SCIA•ESA PT** offers simple and advanced structural analysis software with a unique and consistent integrated structure and analysis model. The proven finite element method allows the user to simply and quickly realize the analysis of plates, walls, frames and mixed 2D/3D structure models. These building elements can be imported directly or indirectly from other drawing applications like e.g. **AliPlan** (Nemetschek), **Revit** (Autodesk) or from any **own company developed applications**.

► **New sections** have been added to the **SCIA•ESA PT web pages**. Besides the existing sections:

- » Product Description
- » Modules / Add-ons
- » System Requirements
- ...the following items have been added:
- » Technical Specifications
- » Demo Movies
- » Screen Shots
- » Applications
- » What's new?

► **International survey** compares the implementation of the **Eurocodes** in the various EU member countries. [more...](#)



► Dear customers, please note that our offices will be closed on the **25th of December 2006** and the **1st of January 2007**. On the **12th of January** we will gather for our yearly **'Kick Off Meeting'** and we will close at 3.00 p.m. Support however can still be obtained on the usual numbers or by e-mail.

EVENTS

► SCIA participates in the **"Nationale Carrièrebeurs 2007"** fair in Amsterdam RAI (NL) on 9 and 10 March 2007 [more ...](#)

UPDATES

Recently the following new software version has been released:

- » **Allplan 2006.1\_5**  
Customers can download these in our **protected download section**.

## TRAINING

In the following months a lot of **trainings** are organised in our offices of **Herk-de-Stad** and **Arnhem** with, among others, the following topics:

### SCIA•ESA PT

- » Basis course
- » Tips & Tricks
- » Concrete
- » Dynamics
- » EC3 Theory en practice
- ...

### Allplan

- » Basis course

Here you find **all training dates with a programme overview** and you can register online.



SCIA•ESA PT 2007  
Splash Screen

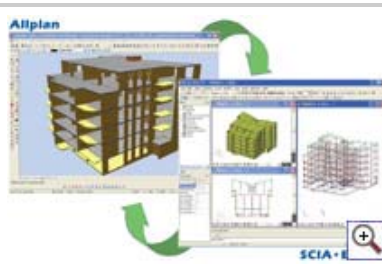

Interoperability between  
SCIA•ESA PT and Allplan

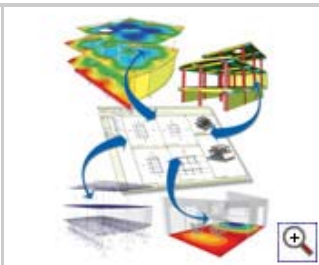

Interoperability between  
SCIA•ESA PT and Revit

The imported structural model is automatically converted and meshed by the powerful **SCIA•ESA PT** solver and subsequently processed via advanced calculation methods for steel, concrete, wood and aluminium. A few examples of further analysis methods are seismic, stability and non-linear calculations, concrete checks, pre-stressing ...

**SCIA•ESA PT** allows users to calculate 2D/3D structures that are processed in CAD Software, via exchange formats such as e.g. **IFC 2x3**. After the analysis it is possible to open the same optimised 3D model again in the drawing program of various building partners. Besides this, the user has the possibility to visualize, present, and analyse the calculation model in a realistic 3D environment and this via the **DWG** or **VRML** format.

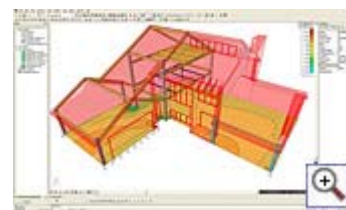

VRML import & export to  
and from SCIA•ESA PT  
2007

Via the open project database it is also possible to steer the **SCIA•ESA PT** solver, visible or in background, by means of **Excel** or own company developed applications. Further it is possible to check and optimise with one single command the various charges or construction phases within a project.

## JOBS

- » SCIA's customers are invited to add their **job vacancies free of charge** in our '**SCIA Jobs Network**'.



Please also check **SCIA's Job Openings**. Good luck!

## SCIA continues its internationalisation on new markets

SCIA has just finished a training program for (new) partners. To this end, the company made a considerable effort with regard to investment and professionalism: the concept "SCIA Business Training Centre" is a fact.



It consists in providing training, at the same time technical and commercial, to candidate partners of SCIA in order to help them to become very quickly effective and profitable on their own domestic market. The training has been spread over two months, partially given in Belgium and partially in the various countries. 28 people coming from 7 countries took part in it.



Partnership contracts were signed in Greece, Turkey and in Croatia and others are still pending. Internal and external teams at SCIA gave the trainings and various assistance tools have also been developed for this purpose. Enthusiastic and trustful in their future successes, the partners went back to their own countries; **the SCIA coaches will support them closely**.

## Project: Electrabel Power Plant in Castelnou (Spain)

Engineering office: **STENDESS n.v.** (B)  
Type: Gas fired combined cycle power plant (800 MW)  
Location: Castelnou, Spain



## GALLERY

- » **SCIA•ESA PT** Open Platform and VRML

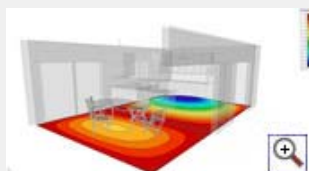
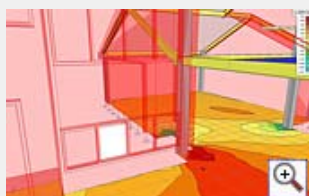

▲ top



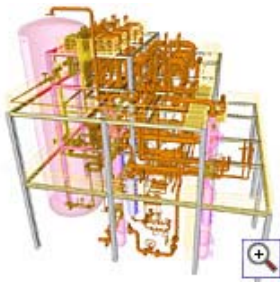

**Contractor:** CMI-group, Seraing, Belgium  
**Total steel weight:**  $\pm 600$  tonnes  
**Dimensions:** 18,5 m x 36,5 m x 65 m

#### About Stendess

Stendess can vouch for the total stability analysis of projects. Their approach covers the initial study through to the end project. With their in-house know-how in steel as well as concrete, the firm is able to offer full study packages for both materials. Thanks to its accumulated know-how and its advanced infrastructure, Stendess can follow up on cross-border projects in accordance with most standards and codes.

#### Technical questions solved by ESA

The challenge in this project was to design a low budget supporting steel structure for a gas fired combined cycle power plant which was situated in a seismic dangerous and high wind speed zone and of which the to be supported weight ( $\pm 2250$  tonnes) was situated at a high level above the ground ( $\pm 30$  m), which is very precarious in a seismic zone. The simulation of the seismic actions was done by static equivalent horizontal loads in accordance to the natural frequency of the structure. Finding the balance between a relatively low stiffness of the whole structure (in order to decrease the seismic impact) and a sufficient supporting structure with expectable deformations was a high creative demand in the static layout and the dimensioning of the structure.

#### PROMOTIONS

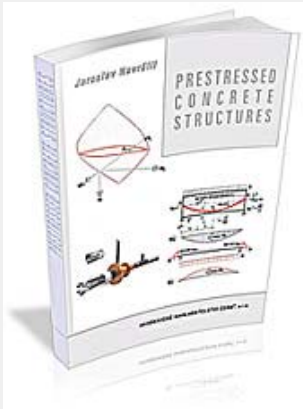

SCIA recommends the recently published book by our colleague **dr. Jaroslav Navratil**: '**Prestressed Concrete Structures**'.

**ORDER NOW!**

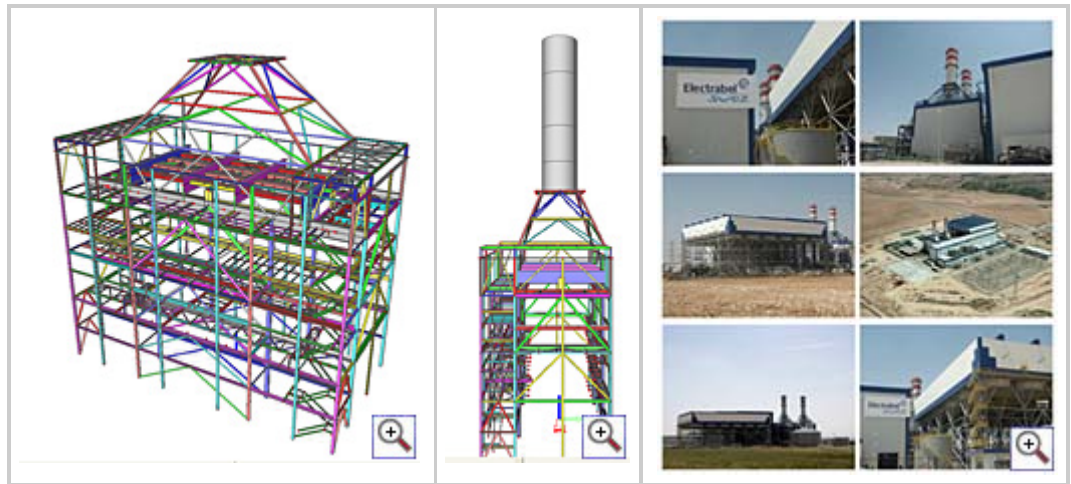

#### How Stendess experienced ESA when realizing the project

"For this project ESA proved its power. The program calculated at high speed large structures with a high number of bars and a high number of combinations. ESA proved that even for large structures the dynamic calculations could be done in an acceptable way and time. Even optimisation of such large structures didn't give many problems. We used the modules: Base, 3D-frame, Dynamics frame and Steel code check (EC3)"

top

#### Tips & Tricks: Partial analyses of structures using layers in SCIA•ESA PT

**During the analysis of large structures, it is often useful to divide the entire structure in several smaller parts for separate analysis and calculation.** Or, for example, when a complete 3D dxf or dwg model is imported in SCIA•ESA PT, a selection can be made for which part of the structure has to be analysed.



**Using layers does the division of large parts in smaller subdivisions.** Each layer can receive properties to indicate its goal.

These properties can be appointed to the layers in the layer manager. Whether to make a layer visible or not is done by marking the property "Active". For excluding a certain layer from the calculation the property "CAD model only" has to be set to "YES".



When performing the calculation, the user will explicitly be told that there are layers, which are set as "CAD model only".

▲ top

#### About this SCIA eNews

- » We would like to encourage you to give us your current e-mail address, if the one we used for this message, would not be correct or if you want us to send it to another address.
- » If you would like to **unsubscribe** from this **eNews**, just send us an e-mail with **'unsubscribe'** as the subject followed by the e-mail address to be deleted.
- » Please let us know if there are any topics in which you are interested. We would also like to hear any suggestions or ideas you may have on improving this eNews. **You can respond here...**

▲ top

SCIA Group nv - Industrieweg 1007 - B-3540 Herk-  
de-Stad  
Tel: +32 13 55 17 75 - Fax: +32 13 55 41 75

Copyright © 2006 - [info@scia-online.com](mailto:info@scia-online.com)  
SCIA International is member of the  
Nemetschek Group  
